



**SAN MARINO INDUSTRIES LLC**  
Italian Design and Innovation

Model # MLV233S



**LED**  
Technology

## Assembly instructions for **MLV233S**

### **WARNING: MAKE SURE POWER SUPPLY IS TURNED OFF AT MAIN BREAKER PRIOR TO INSTALLATION**

- Carefully unpack this light and place all parts on a flat surface. Do not discard any contents until assembly is complete.
- Read all safety precautions and installation instructions carefully before installing or servicing this fixture. Failure to comply with these instructions could result in potentially fatal electric shock and/or property damage.
- It is recommended that a qualified electrician perform all wiring. This fixture must be wired in accordance with all national and local electrical codes.
- Do not handle any energized fixture or attempt to energize any fixture with wet hands or while standing on a wet or damp surface or in water.
- This fixture is designed for use in a 120VAC/60Hz circuit.
- Make sure that the power source conforms to the requirements of the fixture. (See labels on the fixture housing).
- To reduce the risk of electrical shock, and to assure proper operation, this fixture must be adequately grounded. To accomplish proper grounding, there must be a separate ground wire (Bare Copper) contact between this fixture and the ground connection of your main power supply panel.
- This fixture is intended to be used for general indoor lighting in dry or damp locations.

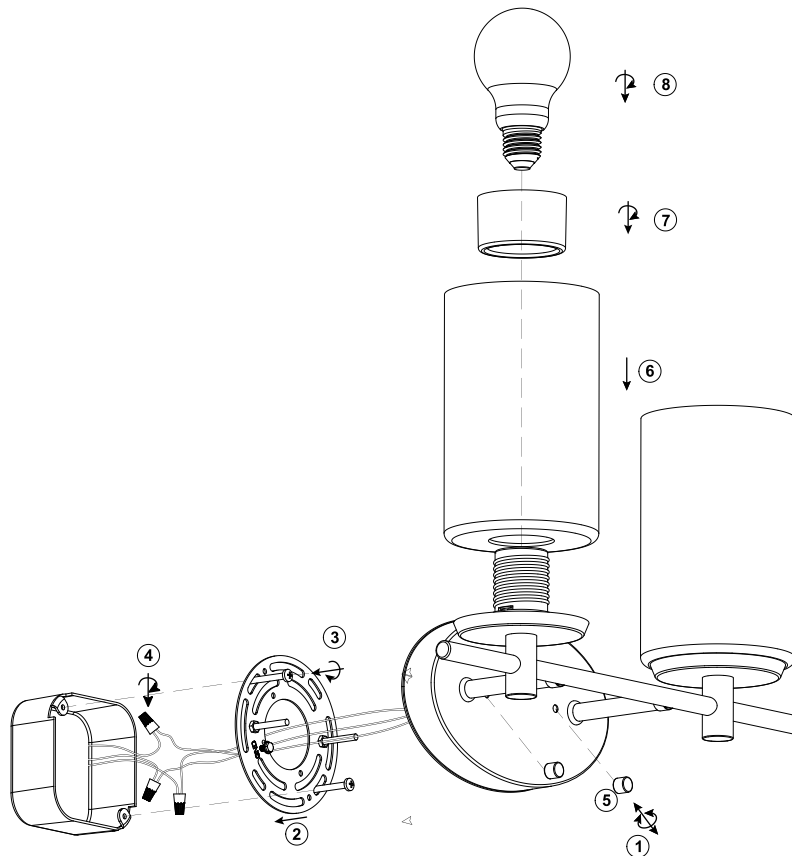

Questions, problems, missing parts? Before returning to your retailer, call our customer service department at +1-984 250 8353.

<https://www.sanmarinoindustries.com>

### **Step 1-Preparing for installation**

1. Remove the Mounting Plate from the Canopy by removing the two flathead nuts
2. Install the Mounting Plate on the Canopy
3. Use fitting screws to lock Mounting Plate

### **Step 2-Wiring fixture -Do not mix wires**

4. Make all wire connections to appropriate wire. Secure with wire nuts (provided).
    - A. Connect the Bare Copper Ground Wire from the fixture to the supply source ground wire.
    - B. Connect the black wire from the fixture to the black (L) wire from supply power source.
    - C. Connect the white wire from the fixture to the white (N) wire from supply power source.
- Do not mix wires.** Pull on each wire lead to make sure connections are secure. Make certain no bare wires are exposed outside of wire connectors, Tuck all connections neatly into the junction box.

### **Step 3 - Installing diffuser**

5. Screws on the junction box. Secure the fixture using flathead Screws
6. Install 2 glass covers.
7. Lock the glass with fixed braces

### **Step 4-Lamping**

8. Install 2x E26 bulb (not included)

This device complies with part 15 of the FCC Rules. Operations is subject to the following two conditions: (1) This device may not cause harmful interference, and (2) this device must accept any interference received, including that may cause undesired operation.

**NOTE:** This equipment has been tested and found to comply with the limits for a Class B digital device, pursuant to Part 15 of the FCC Rules. These limits are designed to provide reasonable protection against harmful interference in a residential installation. This equipment generates, uses and can radiate radio frequency energy and, if not installed and used in accordance with the instructions, may cause harmful interference to radio communications. However, there is no guarantee that interference will not occur in a particular installation. If this equipment does cause harmful interference to radio or television reception, which can be determined by turning the equipment off and on, the user

is encouraged to try to correct the interference by one or more of the following measures:

- Reorient or relocate the receiving antenna.
- Increase the separation between the equipment and receiver.
- Connect the equipment into an outlet on a circuit different from that to which the receiver is connected.
- Consult the dealer or an experienced radio/TV technician for help

**CAUTION: Changes or modifications not expressly approved by the party responsible for compliance could void the user's authority to operate the equipment.**