



**SAN MARINO INDUSTRIES LLC**  
Italian Design and Innovation

**LED**  
Technology  
Model# ZDL1241S

# Patio Light

## Installation Instructions

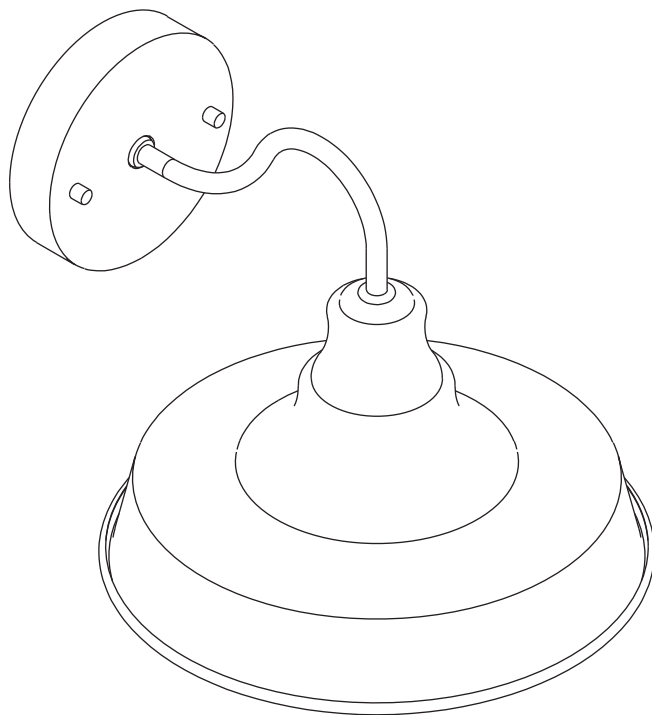

Questions, problems, missing parts? Before returning to your retailer, call our customer service department at +1-984 250 8353.

<https://www.sanmarinoindustries.com>

### PACKAGE CONTENTS

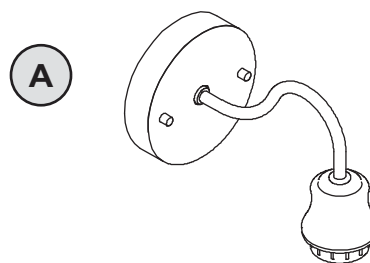

x 4

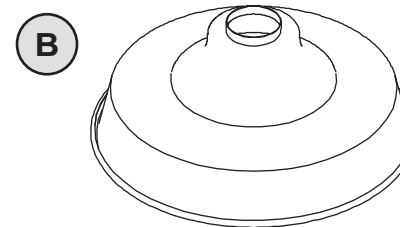

x 4

### HARDWARE CONTENTS



x 8

### INSTALLATION OVERVIEW

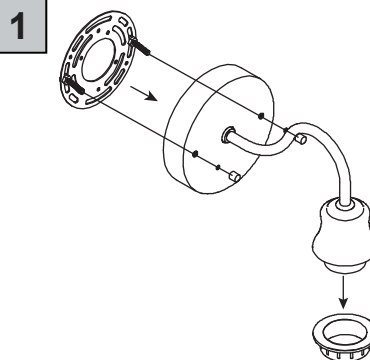

Remove part A, unscrew the hand-tightened nut on the light fixture, take off the Oring silicone gasket, then unscrew and set aside the outer ring from the E26 lamp holder.

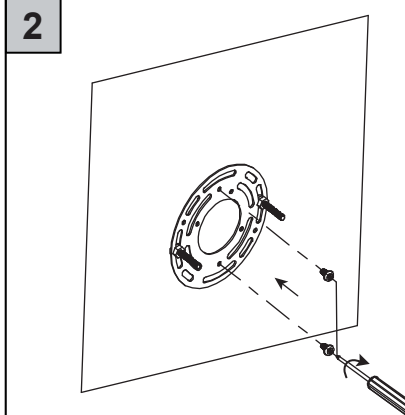

Secure the Bagua plate to the mounting box.

## INSTALLATION OVERVIEW

3

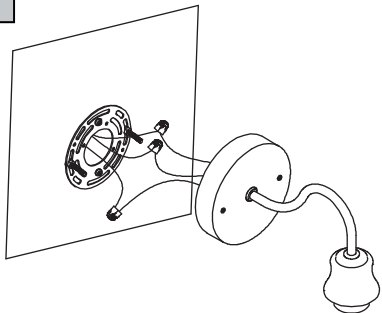

Connect the corresponding wires properly.

4

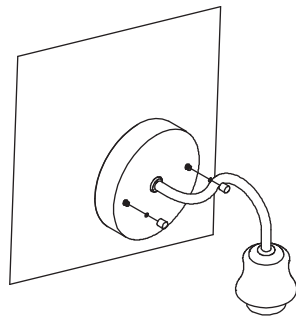

Place the light fixture onto the screws of the Bagua plate, then slide on the silicone gasket and tighten the hand-tightened nut.

5

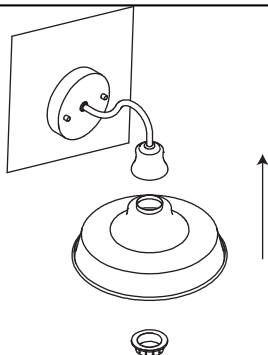

Insert part B into part A, then use the outer ring removed in step one to screw and secure B onto A.

6

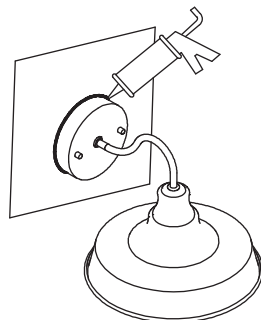

Apply sealant for watertight protection.

7

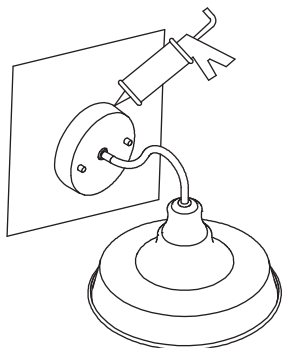

Apply sealant.

8

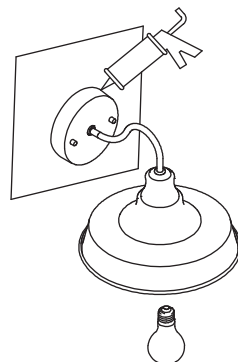

Install the light bulb you have prepared.

## CARE AND MAINTENANCE

- Before attempting to clean the fixture, disconnect the power to the fixture by turning the breaker off or removing the fuse from the fuse box.
- To clean the fixture, use a dry or slightly dampened clean cloth.
- DO NOT use any cleaners with chemicals, solvents or harsh abrasives as damage to the fixture may occur.
- Clean the lens, lamp head and lamp stand regularly with a non-abrasive cleaner.

Warning: Always make sure the flood light is unplugged and completely cool before attempting to clean it.

Made in China